

J. E

TOWNSHIP OF BIRCH RUN

At a regular meeting of the Township Board of the Township of Birch Run, Saginaw County, Michigan, held at the Township Hall on April 12, 1994, beginning at 7:30 p.m., Eastern Standard Time, there were

PRESENT: Edward Magnus, sheila DiBerardino, Larry Russell,  
Joanne Strahm, Jackie Hayes, and Gary St Charles

ABSENT: None

The following preamble and resolution were moved for adoption by Russell and the motion was supported by Hayes:

**RESOLUTION  
REGARDING CERTAIN PROPOSED WATER IMPROVEMENTS  
AND RELATED SPECIAL ASSESSMENT DISTRICTS**

94-6

WHEREAS, the Township Board (the "Board") of the Township of Birch Run, Saginaw County, Michigan (the "Township"), has entered into a Contract for the construction of water improvements (the "Project") with the County of Saginaw (the "County") pursuant to Act No. 185 of the Michigan Public Acts of 1957, as amended; and

WHEREAS, Bartow & King Engineers, Bay City, Michigan, have prepared and submitted to the Township preliminary plans describing the Project and its location in the Township (the "Plans") and a preliminary estimate of the cost of the Project (the "Cost Estimate"); and

WHEREAS, after reviewing the Contract, the Plans and the Cost Estimate, the Township Board desires to proceed with the Project, to levy special assessments against the lands specially benefitted by the Project to defray all or part of the cost of the Project, all pursuant to and as authorized by Act No. 185, Michigan Public Acts of 1957, as amended ("Act 185"); and

WHEREAS, the Township Assessor is preparing and will certify a proposed special assessment roll (the "Roll") for the two Water Assessment Districts (the "Districts"), and the Roll will be filed with the Township Clerk at least 10 days prior to April 26, 1994;

NOW, THEREFORE, BE IT RESOLVED as follows:

1. The Plans and the Cost Estimate are accepted, approved and ordered filed with the Township Clerk, and the summary thereof attached to this resolution as EXHIBIT A is hereby approved and made a part of this resolution.

2. The Township Board hereby tentatively declares its intention to construct the Project and tentatively designates the two special assessment districts named and described in EXHIBIT B against which all or part of the cost of the Project is to be assessed.

3. The Township Board instructs the Township Assessor to certify that (a) the Roll was prepared in accordance with the Township Board's direction, and (b) the Roll was prepared in accordance with the laws of the State of Michigan, including the Act, and the Assessor shall file the Roll with the Township Clerk not later than April 16, 1994.

4. The Board shall meet at 7:00 p.m., Eastern Daylight Savings Time, on Tuesday, April 26, 1994, at the Township Hall during such meeting shall conduct a public hearing to hear objections to the Projects and the Districts as required by law. The form of notice attached hereto as EXHIBIT B is hereby approved as and for the form of notice for such hearing. The Clerk shall cause notice of such hearing, in the form hereby approved to be given as follows:

- (a) To each record owner of, or party in interest in, land in the Districts whose name appears on the last Township tax assessment records (as defined below), by first-class mail addressed to such owner or party at such address, at least 10 days before the date of the hearings, provided, however, that if a record owner's name does not appear in the last Township tax assessment records, such notice shall be given by first-class mail addressed to the record owner at the address shown by the records of the address shown by the records of the Saginaw County Register of Deeds within the time provided in this subparagraph (a);
- (b) By publishing such notice twice in a newspaper circulating in the Township, the first such publication in each newspaper to be at least 10 days before the date of the hearings; and
- (c) To each person (if any) whose name and address has been filed with the Secretary of State of the State of Michigan as a person upon whom may be served notice of any proceedings under Act 188 of the Public Acts of 1954, as amended, by registered mail addressed to such person at such address, or

personally, within five days after the first publication of notice pursuant to subparagraph (b) of this paragraph.

As used in subparagraph (a) of this paragraph, the term "last Township tax assessment records" means the last assessment roll for ad valorem tax purposes which was reviewed by the Township Board of Review, as supplemented by any subsequent changes in the names or the addresses of the owners or parties listed on such roll.

5. In addition to the notices required by paragraph 3 of this resolution, public notice of the meeting referred to shall be given in compliance with the Open Meetings Act (Act No. 267, Public Acts of Michigan, 1976, as amended).

6. All previous resolutions, or parts of previous resolutions, of the Board that are inconsistent with this resolution are hereby rescinded.

A roll-call vote on the foregoing resolution was taken and was as follows:

YES: Magnus, DiBerardino, Russell, Strahm, Hayes, St Charles  
NO: None  
ABSTAIN: None

CLERK'S CERTIFICATE

The undersigned, being the duly qualified and acting Clerk of the Township of Birch Run, Saginaw County, Michigan, hereby certifies that (1) the foregoing is a true and complete copy of a resolution duly adopted by the Township Board at a regular meeting held on April 12, 1994, at which meeting a quorum was present and remained throughout, (2) the original thereof is on file in the records in my office; (3) the meeting was conducted, and public notice thereof was given, pursuant to and in full compliance with the Open Meetings Act (Act No. 267, Public Acts of Michigan, 1976, as amended) and (4) minutes of such meeting were kept and will be or have been made available as required thereby.

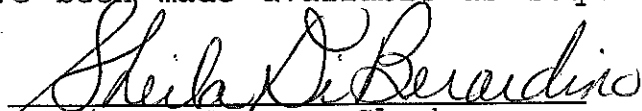
  
Sheila DiBerardino, Clerk

[SEAL]

## Bartow &amp; King Engineers

2500 E. Midland Road, Bay City, MI 48706

WATER SYSTEM EXTENSION  
 BIRCH RUN TOWNSHIP  
 SAGINAW COUNTY, MICHIGAN  
 PROJECT COST ESTIMATE

	<u>VILLAGE SHARE</u>	<u>TOWNSHIP SHARE</u>	<u>TOTAL</u>
1. Birch Run Road Including Water Services		\$ 84,670.00	\$ 84,670.00
2. 12" Waterline West from Dixie Highway to Halo Burger (No Water Services Included)	\$ 19,794.00	8,274.00	28,068.00
3. Dixie Highway North of 12" Waterline to West	47,007.50	47,007.50	94,015.00
4. Dixie Highway Water Services North of 12" Waterline to West		6,725.00	6,725.00
SUBTOTAL CONSTRUCTION ESTIMATE	\$ 66,801.50	\$146,676.50	\$213,478.00
Engineering	6,680.00	\$14,668.00	\$21,348.00
Contingencies	6,680.00	\$14,668.00	\$21,348.00
TOTALS	\$ 80,161.50	\$176,012.50	\$256,174.00

DIXIE HIGHWAY NORTH OF 12" LINE TO WEST

DESCRIPTION	QTY.	UNIT	UNIT PRICE	AMOUNT
12" PVC DR 18 WATERLINE	2970	LF	17.50	51975.00
10" PVC DR 18 WATERLINE	30	LF	16.00	480.00
6" PVC DR 18 WATERLINE	40	LF	12.00	480.00
12" x 12" TEE	1	EA	250.00	250.00
12" x 6" TEE	4	EA	200.00	800.00
12" x 10" TEE	1	EA	250.00	250.00
12" VALVE & BOX	4	EA	850.00	3400.00
6" VALVE & BOX	4	EA	350.00	1400.00
12" 90 BEND	1	EA	180.00	180.00
12" 45 - BEND	2	EA	175.00	350.00
CONNECT TO EX. 12" W.L. w/FITTINGS	1	LS	1000.00	1000.00
BORER & JACK 20" O.D. x 0.250" W.T.				
GRADE & SETTLE CASING UNDER ROADWAYS	155	LF	100.00	15500.00
REMOVE & REPLACE CONC. DRIVEWAY	300	SF	3.50	1050.00
HYDRANTS	4	EA	1000.00	4000.00
TUNNEL HEADWALL	5	EA	250.00	1250.00
15" CMP CURVE	20	LF	20.00	400.00
REMOVE & REPLACE COMMERCIAL				
BIT. DRIVE (350 P/ASYD)	2080	SF	3.50	7280.00
CONNECT TO 10" W.L. w/FITTINGS	1	LS	1000.00	1000.00
SIFF RESTORATION	2970	LF	1.00	2970.00
			TOTAL \$	94015.00

WATER SERVICE DIXIE HIGHWAY NORTH OF 12" LINE TO WEST

DESCRIPTION	QTY.	UNIT	UNIT PRICE	AMOUNT
FAR SERVICE (2" DIAMETER)	1	EA	1500.00	1500.00
FAR SERVICE (1" DIAMETER)	4	EA	900.00	3600.00
NEAR SERVICE (1" DIAMETER)	5	EA	325.00	1625.00
			TOTAL \$	6725.00

DIXIE HIGHWAY SOUTH OF 12" LINE TO WEST

DESCRIPTION	QTY.	UNIT	UNIT PRICE	AMOUNT
12" PVC DR 18 WATER LINE	1230	LF	17.50	21525.00
4" PVC DR 18 WATER LINE	50	LF	12.00	600.00
12" x 12" TEE	4	EA	250.00	1000.00
12" x 6" TEE	4	EA	200.00	800.00
12" VALVE & BOX	4	EA	850.00	3400.00
8" VALVE & BOX	1	EA	500.00	500.00
6" VALVE & BOX	4	EA	350.00	1400.00
12" PLUG	3	EA	65.00	195.00
2" PLUG	1	EA	65.00	65.00
BORH & JACK 40" O.D. x 0.250" W.T.				
GRADE B SILEX CASING UNDER ROADWAYS	70	LF	100.00	7000.00
REMOVL & REPLACE CONC. DRIVEWAY	510	SF	3.50	1785.00
HYDRANTS	4	EA	1000.00	4000.00
12" x 8" REDUCER	1	EA	150.00	150.00
TUNNEL HEADWALL	5	EA	250.00	1250.00
15" CONC. CHIMNEY	40	LF	30.00	1200.00
15" CONC. FLARED END SECTION	1	EA	400.00	400.00
REMOVE & REPLACE RESIDENTIAL				
RET. DRIVE (250' BY 50')	150	SF	2.50	375.00
EAR SERVICE (1" DIAMETER)	1	EA	900.00	900.00
HEAR SERVICE (1" DIAMETER)	7	EA	325.00	2275.00
SITE RESTORATION	1230	LF	1.00	1230.00
		TOTAL	\$	50050.00

KIRCH RUC ROAD

DESCRIPTION	QTY.	UNIT	UNIT PRICE	AMOUNT
12" PVC DR 18 WATERLINE	2400	LF	17.50	42000.00
6" PVC DR 18 WATERLINE	50	LF	12.00	600.00
12"x 12" TIE	1	EA	250.00	250.00
12"x 6" TIE	4	EA	200.00	800.00
12" VALVE & BOX	2	EA	850.00	1700.00
6" VALVE & BOX	4	EA	350.00	1400.00
12" 90 - BEND	1	EA	180.00	180.00
12" 45 - BEND	2	EA	175.00	350.00
12" PLUG	2	EA	65.00	130.00
BORF & JACK 20" O.D. x 0.250" W.T.				
GRADE B TIE CASES UNDER ROADWAYS	190	LF	100.00	19000.00
REMOVE & REPLACE CONC. DRIVEWAY	760	SF	3.50	2660.00
HYDRANTS	4	EA	1000.00	4000.00
REMOVE & REPLACE RESIDENTIAL BIT. DRIVE (250 #/SYD)	550	SF	2.50	1375.00
REMOVE & REPLACE COMMERCIAL BIT. DRIVE (250 #/SYD)	750	SF	3.50	2625.00
WEAR SERVICE (1" DIAMETER)	16	EA	325.00	5200.00
GUT RESTORATION	2400	LF	1.00	2400.00
			TOTAL \$	84670.00



VILLAGE 100% COST (WEST) IN EASEMENT

DESCRIPTION	QTY.	UNIT	UNIT PRICE	AMOUNT
12" PVC DR 18 WATERLINE	440	LF	17.50	7700.00
6" PVC DR 18 WATERLINE	5	LF	12.00	60.00
12" x 12" TEE	1	EA	250.00	250.00
12" x 6" TEE	1	EA	200.00	200.00
12" VALVE & BOX	1	EA	850.00	850.00
6" VALVE & BOX	1	EA	350.00	350.00
12" 90 - ELB	3	EA	180.00	540.00
12" PLUG	2	EA	65.00	130.00
HYDRANTS	1	EA	1000.00	1000.00
SITE RESTORATION	440	LF	1.00	440.00
			TOTAL \$	11520.00

VILLAGE/TOWNSHIP 100% IN EASEMENT & 12" LINE TO HYDRANT

DESCRIPTION	QTY.	UNIT	UNIT PRICE	AMOUNT
12" PVC DR 18 WATERLINE	735	LF	17.50	12862.50
6" PVC DR 18 WATERLINE	5	LF	12.00	60.00
12" x 12" TEE	1	EA	250.00	250.00
12" x 6" TEE	1	EA	200.00	200.00
12" VALVE & BOX	1	EA	850.00	850.00
6" VALVE & BOX	1	EA	350.00	350.00
12" 45 - ELB	1	EA	180.00	180.00
12" PLUG	1	EA	65.00	65.00
HYDRANTS	1	EA	1000.00	1000.00
SITE RESTORATION	735	LF	1.00	735.00
			TOTAL \$	16552.50

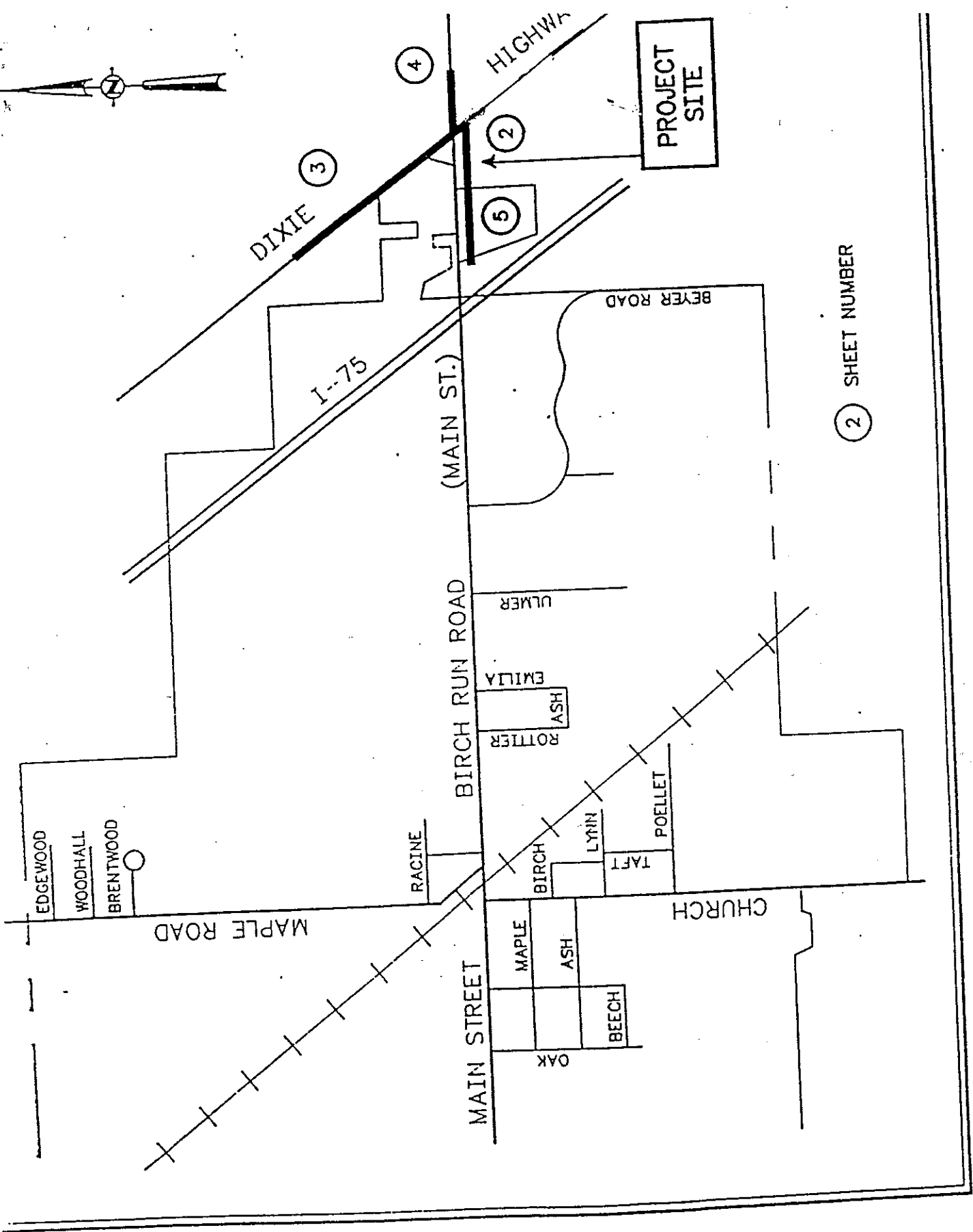
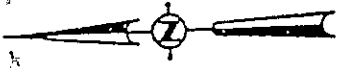

PROJECT LOCATION  
NO SCALE

NEW BIRCH RUN TOWNSHIP  
WATER IMPROVEMENTS

Construction Costs Including Construction Contingency	\$236,086.50
Financing Costs	13,500.00
Contingency	<u>413.50</u>
Total	\$250,000.00

las.R-SAG18.doc

# Bartow & King Engineers

2500 E. Midland Road, Bay City, MI 48706

WATER SYSTEM IMPROVEMENTS  
BIRCH RUN TOWNSHIP  
SAGINAW COUNTY, MICHIGAN

## SUMMARY OF CONSTRUCTION COSTS

### Birch Run Water System Improvements

Lange Road between S. Beyer Rd. & Dehmel Road	\$83,090.00
Dehmel Road 600 feet South of Lange Road	15,340.00
Dehmel Road 700 feet North of Lange Road	12,440.00
Lange Road between Dehmel & Gera Roads	81,560.00
E. Townline Road between Dehmel & Gera Roads	72,980.00
S. Gera Road between Lange & E. Townline Roads	34,660.00
S. Gera Road between Busch & Lange Roads	44,650.00
Lange Road 1200 feet East of S. Gera Road	21,850.00
Evergreen Subdivision	57,950.00
S. Beyer Road 400 feet North of Lange Road	6,470.00
S. Beyer Road between Busch and Lange Roads	43,530.00
Busch Road 2650 feet East of S. Beyer Road	46,920.00
S. Beyer Road - Busch Road South 3,100 feet	53,960.00
Design & Construction Engineering	69,100.00
Project Contingencies	60,000.00

PROJECT COSTS

\$704,500.00

Number of parcels Area = \_\_\_\_\_

Estimated Cost per parcel not including bonding  
costs and interest \_\_\_\_\_

BKE #931108  
January 14, 1994  
Revised January 27, 1994  
Revised January 28, 1994

(517) 684-8850

A-7

Fax (517) 684-8404

NEW BIRCH RUN TOWNSHIP  
WATER IMPROVEMENTS

Construction Costs Including construction contingency	\$704,500
Financing Costs	19,025
Contingency	<u>1,475</u>
Total	\$725,000

jra.SAG19fee

EXHIBIT B

**NOTICE OF PUBLIC HEARING  
TOWNSHIP OF BIRCH RUN, SAGINAW COUNTY**

TO: ALL RECORD OWNERS OF, AND PARTIES IN INTEREST IN, LAND  
IN THE PROPOSED SPECIAL ASSESSMENT DISTRICTS DESCRIBED  
HEREIN

NOTICE IS HEREBY GIVEN that the Township Board of the  
TOWNSHIP OF BIRCH RUN, Saginaw County, Michigan (the "Township"),  
will meet at 7:00 p.m., Eastern Daylight Savings Time, on April  
26, 1994, at the Birch Run Township Hall, 8411 Main Street, Birch  
Run, Michigan, and during such meeting will conduct a public  
hearing to hear objections to water improvement projects, the  
cost thereof and the special assessment roll therefor for the  
construction of water mains as follows:

**WATER PROJECTS  
Descriptions of Proposed Improvements**

**SEE APPENDIX A**

in the special assessment districts described herein (the  
"Projects"), and to hear objections to the following special  
assessment districts tentatively designated by the Township Board,  
as the districts against which the cost of the Project is to be  
assessed:

**SPECIAL ASSESSMENT DISTRICT**

Property located in the TOWNSHIP OF BIRCH RUN, Saginaw  
County, Michigan described as follows:

[INSERT DESCRIPTION OF DISTRICT]

**SPECIAL ASSESSMENT DISTRICT**

Property located in the TOWNSHIP OF BIRCH RUN, Saginaw  
County, Michigan described as follows:

[INSERT DESCRIPTION OF DISTRICT]

NOTICE IS HEREBY FURTHER GIVEN that preliminary plans describing the Projects and the location in the Township and a preliminary estimate of the cost of the Project prepared by Bartow & King Engineers of Bay City, Michigan, and a proposed special assessment roll, prepared by the Township Assessor are on file with the Township Clerk, at \_\_\_\_\_ office at 8411 Main Street, Birch Run, Michigan, for public examination during regular business hours, which are between \_\_\_\_\_ and \_\_\_\_\_ :00 p.m. Monday through Friday.

NOTICE IS FURTHER GIVEN that, in order to provide for such special assessments, a special assessment roll (the "Special Assessment Roll") has been prepared and is on file in the office of the Township Clerk for public examination during the same hours as set forth above.

NOTICE IS FURTHER GIVEN that the Township Board will hold a public hearing on \_\_\_\_\_ day of \_\_\_\_\_, 1994, at \_\_\_\_\_, Eastern Daylight Savings Time, at \_\_\_\_\_ Michigan for the purpose of reviewing and hearing any objections to the project and the Special Assessment Roll. Any person objecting to the Special Assessment Roll shall file his or her objections in writing before the close of the public hearing or within such further time, if any, as the Township Board may grant.

PLEASE TAKE FURTHER NOTICE that the owner or any person having an interest in property that is specially assessed may file a written appeal with the Michigan Tax Tribunal within thirty (30) days after confirmation of the special assessment roll. However, appearance and protest at the public hearing on the special assessment roll are required in order to appeal the special assessment to the Michigan Tax Tribunal. An owner or other party in interest or his or her agent may (1) appear in person at the hearing to protest the special assessment, or (2) file his or her appearance or protest by letter before the close of the hearing. The Township Clerk shall maintain a record of parties who appear to protest at the hearing. If the hearing is terminated or adjourned for the day before a party is provided the opportunity to be heard, a party whose appearance was recorded shall be considered to have protested the special assessment in person.

BY ORDER OF THE TOWNSHIP BOARD,  
SHEILA Diberardino, clerk :

Dated: \_\_\_\_\_, 1994

Publish: \_\_\_\_\_

las.R-BIR

# Bartow & King Engineers

2500 E. Midland Road, Bay City, MI 48706

**WATER SYSTEM EXTENSION  
BIRCH RUN TOWNSHIP  
SAGINAW COUNTY, MICHIGAN  
PROJECT COST ESTIMATE**

	<u>VILLAGE SHARE</u>	<u>TOWNSHIP SHARE</u>	<u>TOTAL</u>
1. Birch Run Road Including Water Services		\$ 84,670.00	\$ 84,670.00
2. 12" Waterline West from Dixie Highway to Halo Burger (No Water Services Included)	\$ 19,794.00	8,274.00	28,068.00
3. Dixie Highway North of 12" Waterline to West	47,007.50	47,007.50	94,015.00
4. Dixie Highway Water Services North of 12" Waterline to West		<u>6,725.00</u>	<u>6,725.00</u>
<b>SUBTOTAL CONSTRUCTION ESTIMATE</b>	<b>\$ 66,801.50</b>	<b>\$146,676.50</b>	<b>\$213,478.00</b>
Engineering	6,680.00	\$14,668.00	\$21,348.00
Contingencies	<u>6,680.00</u>	<u>\$14,668.00</u>	<u>\$21,348.00</u>
<b>TOTALS</b>	<b>\$ 80,161.50</b>	<b>\$176,012.50</b>	<b>\$256,174.00</b>



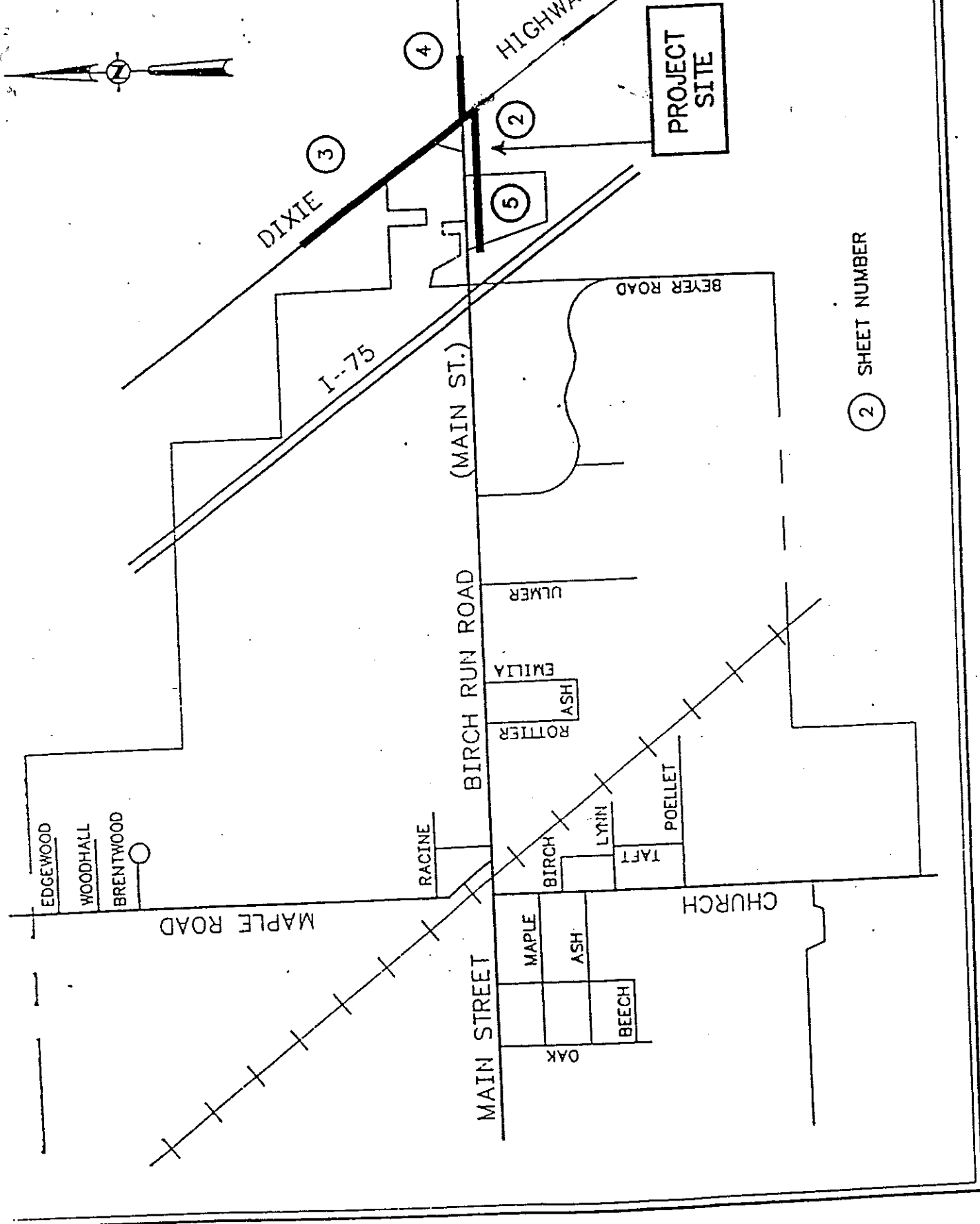
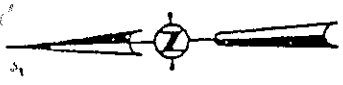

2 SHEET NUMBER

PROJECT LOCATION  
NO SCALE

NEW BIRCH RUN TOWNSHIP  
WATER IMPROVEMENTS

Construction Costs Including Construction Contingency	\$236,086.50
Financing Costs	13,500.00
Contingency	<u>413.50</u>
Total	\$250,000.00

las.R-SAG18.doc

# Bartow & King Engineers

2500 E. Midland Road, Bay City, MI 48706

WATER SYSTEM IMPROVEMENTS  
BIRCH RUN TOWNSHIP  
SAGINAW COUNTY, MICHIGAN

## SUMMARY OF CONSTRUCTION COSTS

### Birch Run Water System Improvements

Lange Road between S. Beyer Rd. & Dehmel Road	\$83,090.00
Dehmel Road 600 feet South of Lange Road	15,340.00
Dehmel Road 700 feet North of Lange Road	12,440.00
Lange Road between Dehmel & Gera Roads	81,560.00
E. Townline Road between Dehmel & Gera Roads	72,980.00
S. Gera Road between Lange & E. Townline Roads	34,660.00
S. Gera Road between Busch & Lange Roads	44,650.00
Lange Road 1200 feet East of S. Gera Road	21,850.00
Evergreen Subdivision	57,950.00
S. Beyer Road 400 feet North of Lange Road	6,470.00
S. Beyer Road between Busch and Lange Roads	43,530.00
Busch Road 2650 feet East of S. Beyer Road	46,920.00
S. Beyer Road - Busch Road South 3,100 feet	53,960.00
Design & Construction Engineering	69,100.00
Project Contingencies	<u>60,000.00</u>

PROJECT COSTS

\$704,500.00

Number of parcels Area = \_\_\_\_\_

Estimated Cost per parcel not including bonding  
costs and interest \_\_\_\_\_

BKE #931108  
January 14, 1994  
Revised January 27, 1994  
Revised January 28, 1994

(517) 684-8850

Fax (517) 684-8404

NEW BIRCH RUN TOWNSHIP  
WATER IMPROVEMENTS

Construction Costs Including construction contingency	\$704,500
Financing Costs	19,025
Contingency	<u>1,475</u>
Total	\$725,000

jra.SAG19fee