

RESOLUTION 94-1

RESOLUTION TO INITIATE PROJECT

At a regular meeting of the Township Board of the Township of Birch Run, Saginaw County, Michigan, held in the Township Hall on the 11th day of January, 1994 at 7:30 p.m., Eastern Standard Time, there were

PRESENT: Edward Magnus, Sheila DiBerardino, Katrina Zietz,
Jackie Hayes, Joanne Strahm, Larry Russell

ABSENT: Gary St.Charles

The following resolution was offered by Russell and seconded by Hayes:

WHEREAS, the Township of Birch Run (the "Township"), desires to extend its watermain system to serve parts of the Township as is described in Appendix A (the "Project"); and

WHEREAS, it appears to be most advantageous and feasible that the County of Saginaw (the "County"), through its Department of Public Works (the "DPW"), provide such extensions and acquire and finance such by the issuance of bonds in anticipation of the collection of amounts to become due under a contract between the County and the Township; and

WHEREAS, the Township will agree to pay the cost of the acquisition of said watermain extension, all pursuant to Act No. 185, Michigan Public Acts of 1957, as amended ("Act 185").

NOW, THEREFORE, BE IT RESOLVED by the Township Board of the Township of Birch Run, Saginaw County, Michigan, as follows:

1. The County is hereby requested to construct the Project in accordance with plans and specifications prepared by Bartow & King Engineers, Bay City, Michigan, all as described in Appendix A. Such Project is to be financed pursuant to the provisions of Act 185.

2. The County and the Township shall hereafter enter into an appropriate contract with respect to the establishment, construction, operation and financing of such Township water improvements.

3. The Township hereby agrees to reimburse the County for all reasonable engineering and administrative costs hereafter actually incurred by the DPW in connection with the study, planning and acquisition of said watermains in the event that, for some reason beyond the control of the County, the County system is not completed or the bonds to finance the same are not sold.

4. The Township also requests that Municipal Financial Consultants Incorporated shall act as the financial consultants for the Project and John R. Axe and Associates shall act as bond counsel for the Project.

A vote on the foregoing resolution was taken and was as follows:

YES: Edward Magnus, Sheila DiBerardino, Katrina Zietz,
 Jackie Hayes, Larry Russell

NO: Joanne Strahm

ABSTAIN: (Gary St.Charles absent from meeting)

STATE OF MICHIGAN)
) SS
 COUNTY OF SAGINAW)

The undersigned, being the duly qualified and acting Clerk of the Township of Birch Run, Saginaw County, Michigan, hereby certifies that (1) the foregoing is a true and complete copy of a resolution duly adopted by the Township Board at a regular meeting held on January 11, 1994, at which meeting a quorum was present and remained throughout, (2) that an original thereof is on file in the records of the Township, (3) the meeting was conducted, and public notice thereof was given, pursuant to and in full compliance with the Open Meetings Act (Act No. 267, Public Acts of Michigan, 1976, as amended), and (4) minutes of such meeting were kept and will be or have been made available as required thereby.

DATED: January 13, 1994

Sheila A. DiBerardino

 Sheila A. DiBerardino
 Clerk

[SEAL]

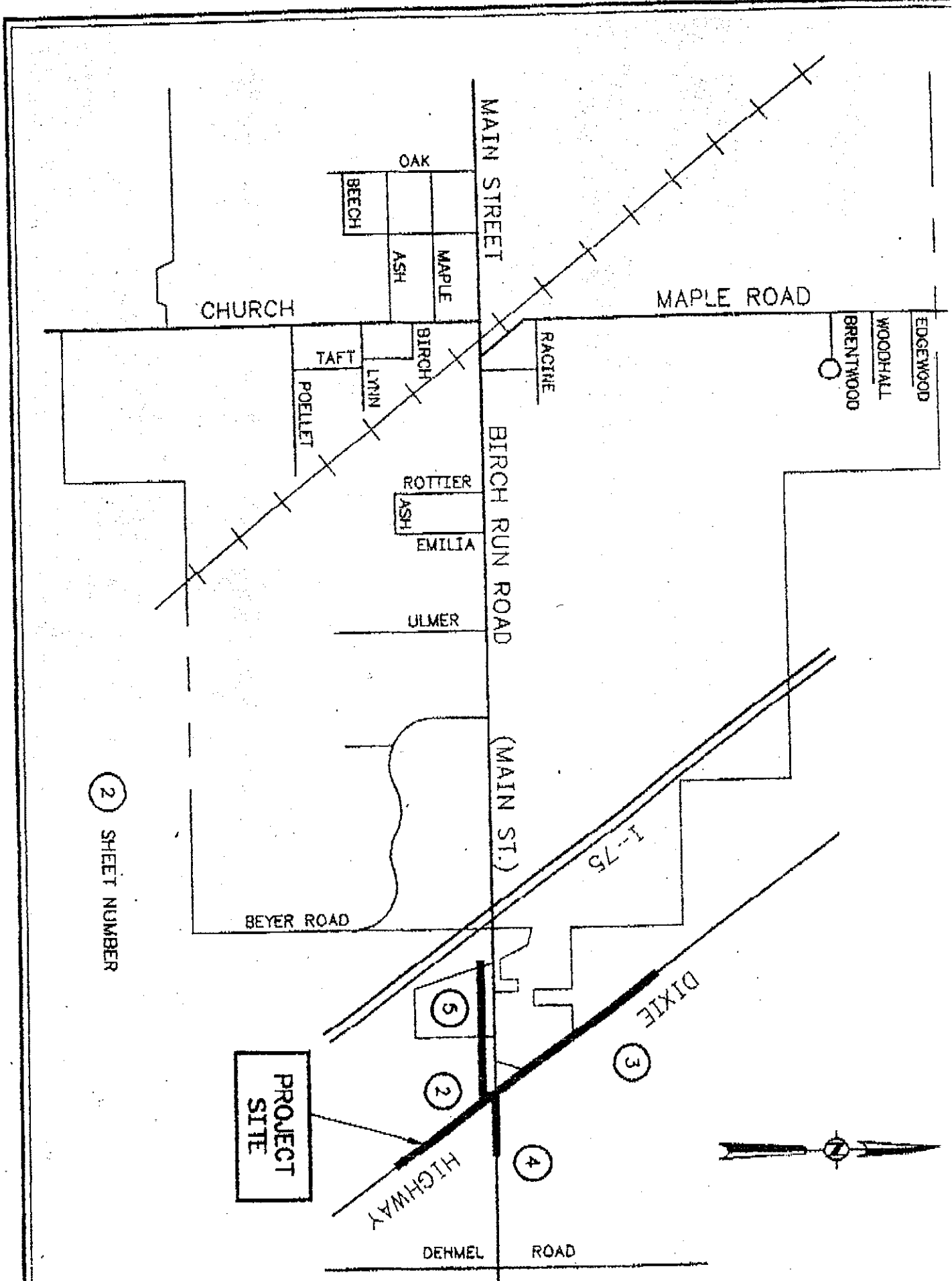

PROJECT LOCATION

NO SCALE

2 SHEET NUMBER

Bartow & King Engineers

2500 E. Midland Road, Bay City, MI 48706

WATER SYSTEM EXTENSION
BIRCH RUN TOWNSHIP
SAGINAW COUNTY, MICHIGAN
PROJECT COST ESTIMATE

	<u>VILLAGE SHARE</u>	<u>TOWNSHIP SHARE</u>	<u>TOTAL</u>
1. Birch Run Road Including Water Services		\$ 84,670.00	\$ 84,670.00
2. 12" Waterline West from Dixie Highway to Halo Burger (No Water Services Included)	\$ 19,794.00	8,274.00	28,068.00
3. Dixie Highway South of 12" Waterline to West Including Water Services		50,050.00	50,050.00
4. Dixie Highway North of 12" Waterline to West	47,007.50	47,007.50	94,015.00
5. Dixie Highway Water Services North of 12" Waterline to West		<u>6,725.00</u>	<u>6,725.00</u>
SUBTOTAL CONSTRUCTION ESTIMATE	\$ 66,801.50	\$196,726.50	\$263,528.00
Engineering	6,680.00	19,680.00	26,360.00
Contingencies	<u>6,680.00</u>	<u>19,680.00</u>	<u>26,360.00</u>
TOTALS	\$ 80,161.50	\$236,086.50	\$316,248.00

DIXIE HIGHWAY NORTH OF 12" LINE TO WEST

DESCRIPTION	QTY.	UNIT	UNIT PRICE	AMOUNT
12" PVC DR 18 WATERLINE	2970	LF	17.50	51975.00
10" PVC DR 18 WATERLINE	30	LF	16.00	480.00
6" PVC DR 18 WATERLINE	40	LF	12.00	480.00
12"x 12" ILL	1	EA	250.00	250.00
12"x 6" TFF	4	EA	200.00	800.00
12"x 10" ILL	1	EA	250.00	250.00
12" VALVE & BOX	4	EA	850.00	3400.00
6" VALVE & BOX	4	EA	350.00	1400.00
12" 90 - BEND	1	EA	180.00	180.00
12" 45 - BEND	2	EA	175.00	350.00
CONNECT TO EX. 12" W.L. w/FITTINGS	1	LS	1000.00	1000.00
BORE & JACK 20" O.D. x 0.250" W.T.				
GRADE B STEEL CASING UNDER ROADWAYS	155	LF	100.00	15500.00
REMOVE & REPLACE CONC. DRIVEWAY	300	SF	3.50	1050.00
HYDRANTS	4	EA	1000.00	4000.00
TUNNEL HEADWALL	5	EA	250.00	1250.00
15" CMP CULVERT	20	LF	20.00	400.00
REMOVE & REPLACE COMMERCIAL				
BIT. DRIVE (350 #/SYD)	2080	SF	3.50	7280.00
CONNECT TO 10" W.L. w/FITTINGS	1	LS	1000.00	1000.00
SITE RESTORATION	2970	LF	1.00	2970.00
			TOTAL \$	94015.00

WATER SERVICES DIXIE HIGHWAY NORTH OF 12" LINE TO WEST

DESCRIPTION	QTY.	UNIT	UNIT PRICE	AMOUNT
FAR SERVICE (2" DIAMETER)	1	EA	1500.00	1500.00
FAR SERVICE (1" DIAMETER)	4	EA	900.00	3600.00
NEAR SERVICE (1" DIAMETER)	5	EA	325.00	1625.00
			TOTAL \$	6725.00

DIXIE HIGHWAY SOUTH OF 12" LINE TO WEST

DESCRIPTION	QTY.	UNIT	UNIT PRICE	AMOUNT
12" PVC DR 18 WATERLINE	1230	LF	17.50	21525.00
6" PVC DR 18 WATERLINE	50	LF	12.00	600.00
12" x 12" TEE	4	EA	250.00	1000.00
12" x 6" TEE	4	EA	200.00	800.00
12" VALVE & BOX	4	EA	850.00	3400.00
8" VALVE & BOX	1	EA	500.00	500.00
6" VALVE & BOX	4	EA	350.00	1400.00
12" PLUG	3	EA	65.00	195.00
8" PLUG	1	EA	65.00	65.00
KORF & JACK 20" O.D. x 0.250" W.T.				
GRADE B STILL CASING UNDER ROADWAYS	70	LF	100.00	7000.00
REMOVL & REPLACE CONC. DRIVEWAY	510	SF	3.50	1785.00
HYDRANTS	4	EA	1000.00	4000.00
12" x 8" REDUCER	1	EA	150.00	150.00
TUNNEL HEADWALL	5	EA	250.00	1250.00
15" CONC. CULVERT	40	LF	30.00	1200.00
15" CONC. FLARED END SECTION	1	EA	400.00	400.00
REMOVE & REPLACE PRESIDENTIAL				
BIT. DRIVE (250 H/SYD)	150	SF	2.50	375.00
LAR SERVICE (1" DIAMETER)	1	EA	900.00	900.00
NEAR SERVICE (1" DIAMETER)	7	EA	325.00	2275.00
SITE RESTORATION	1230	LF	1.00	1230.00
			TOTAL \$	50050.00

BIRCH RUN ROAD

DESCRIPTION	QTY.	UNIT	UNIT PRICE	AMOUNT
12" PVC DR 18 WATERLINE	2400	LF	17.50	42000.00
6" PVC DR 18 WATERLINE	50	LF	12.00	600.00
12"x 12" TEE	1	EA	250.00	250.00
12"x 6" TEE	4	EA	200.00	800.00
12" VALVE & BOX	2	EA	850.00	1700.00
6" VALVE & BOX	4	EA	350.00	1400.00
12" 90 - BEND	1	EA	180.00	180.00
12" 45 - BEND	2	EA	175.00	350.00
12" PLUG	2	EA	65.00	130.00
BORF & JACK 20" O.D. x 0.250" W.T.				
GRADE B STEEL CASTING UNDER ROADWAYS	190	LF	100.00	19000.00
REMOVE & REPLACE CONC. DRIVEWAY	760	SF	3.50	2660.00
HYDRANTS	4	EA	1000.00	4000.00
REMOVE & REPLACE RESIDENTIAL				
BIT. DRIVE (250 #/SYD)	550	SF	2.50	1375.00
REMOVE & REPLACE COMMERCIAL				
BIT. DRIVE (350 #/SYD)	750	SF	3.50	2625.00
NEAR SERVICE (1" DIAMETER)	16	EA	325.00	5200.00
SITE RESTORATION	2400	LF	1.00	2400.00
			TOTAL \$	84670.00

VILLAGE 100% COST (WEST) IN EASEMENT

DESCRIPTION	QTY.	UNIT	UNIT PRICE	AMOUNT
12" PVC DR 18 WATERLINE	440	LF	17.50	7700.00
6" PVC DR 18 WATERLINE	5	LF	12.00	60.00
12"x 12" TEE	1	EA	250.00	250.00
12"x 6" TEE	1	EA	200.00	200.00
12" VALVE & BOX	1	EA	850.00	850.00
6" VALVE & BOX	1	EA	350.00	350.00
12" 90 - BEND	3	EA	180.00	540.00
12" PLUG	2	EA	65.00	130.00
HYDRANTS	1	EA	1000.00	1000.00
SITE RESTORATION	440	LF	1.00	440.00
			TOTAL \$	11520.00

VILLAGE/TOWNSHIP LINE IN EASEMENT & 12" LINE TO HYDRANT

DESCRIPTION	QTY.	UNIT	UNIT PRICE	AMOUNT
12" PVC DR 18 WATERLINE	735	LF	17.50	12862.50
6" PVC DR 18 WATERLINE	5	LF	12.00	60.00
12"x 12" TEE	1	EA	250.00	250.00
12"x 6" TEE	1	EA	200.00	200.00
12" VALVE & BOX	1	EA	850.00	850.00
6" VALVE & BOX	1	EA	350.00	350.00
12" 45 - BEND	1	EA	180.00	180.00
12" PLUG	1	EA	65.00	65.00
HYDRANTS	1	EA	1000.00	1000.00
SITE RESTORATION	735	LF	1.00	735.00
			TOTAL \$	16552.50